



High efficiency, dry and contact free compression claw vacuum pumps

- Capacities ranging from 156 to 188 acfm
- Ultimate vacuum at continuous operation: 29.1 inHg
- Fitted as standard with flange motor
- Air cooling by integrated fan
- Standard features include silencing hood, fine mesh filter, vacuum non-return valve on suction side

Technical Data

			VLU 301
Nominal suction capacity	ACFM	50 Hz	156
		60 Hz	188
Ultimate vacuum at continuous operation	torr(abs) / inHgV	50 Hz	23 / 29.0
		60 Hz	23 / 29.0
Motor rating	hp	50 Hz	10 HP
		60 Hz	
Full load amps	A	50 Hz	14.0 / 8.1
		60 Hz	23.2 / 11.6
Speed	RPM	50 Hz	2935
		60 Hz	3510
Average noise level	dB(A) <i>EN ISO 3744</i>	50 Hz	74
		60 Hz	77
Max. Weight without motor	lbs		477
Oil capacity	qt		1.6

AFCM * refers to suction conditions at inlet connection

Curves and tables content (tolerance ±10 %) according to PNEUROP standards and refer to vacuum pump at normal operating temperature 1 atm or 760 torr, 68 °F.

Measuring surface sound pressure level according to EN ISO 3744, measured with an equivalent unit at a distance of 3 ft. The pump is throttled to 300 torr (abs) suction pressure, with suction side piping connected and vacuum relief valves fitted, tolerance ± 3 dB (A).

The picture shows possibly optional accessories.

We reserve the right to alter technical information!

Dimensions [in]

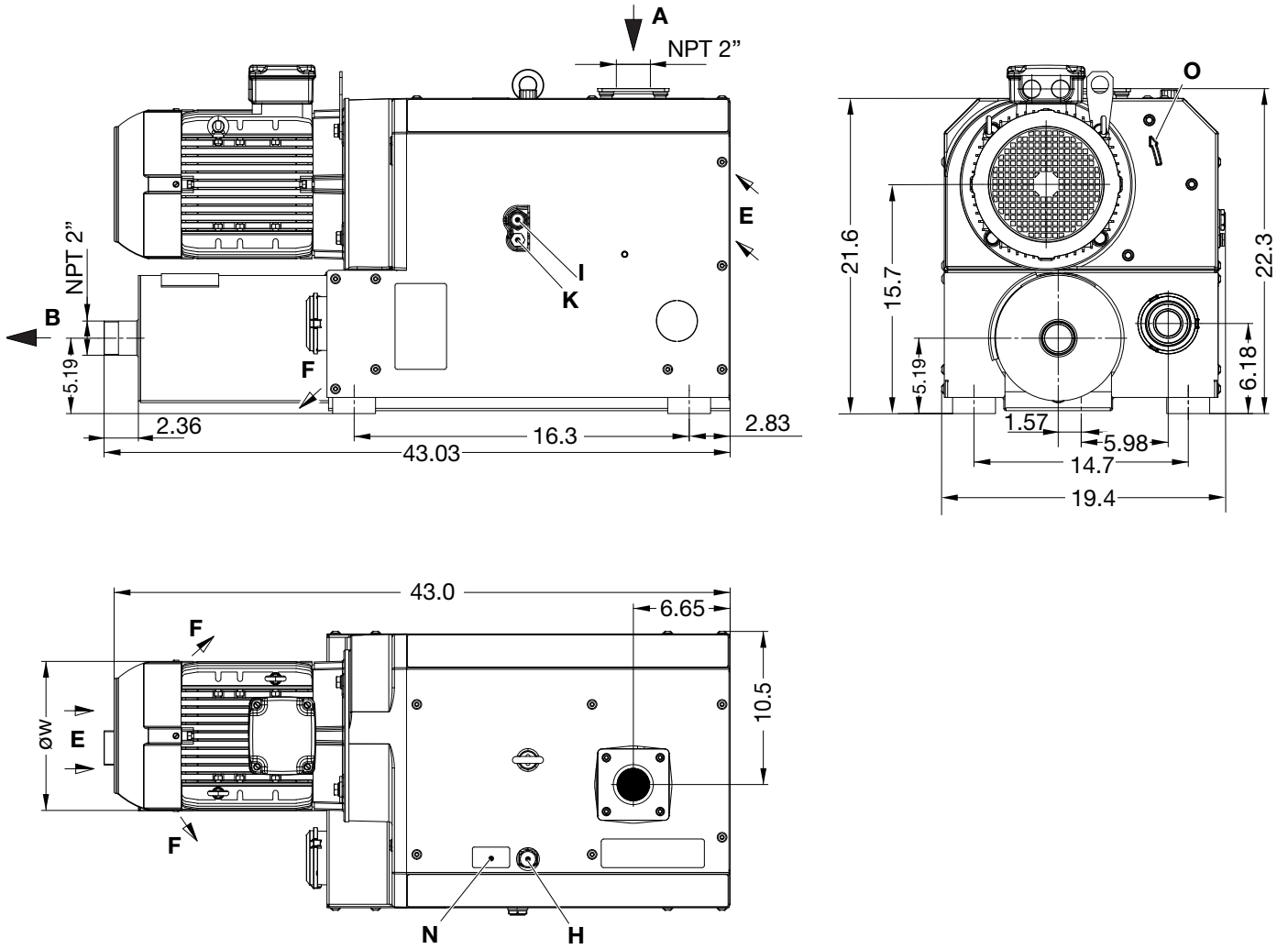

A	Vacuum connection
B	Exhaust
E	Cooling air inlet
F	Cooling air outlet
H	Oil filling point
I	Oil sight glass
K	Oil drain point
N	Data plate
O	Direction of rotation

Characteristic Curves

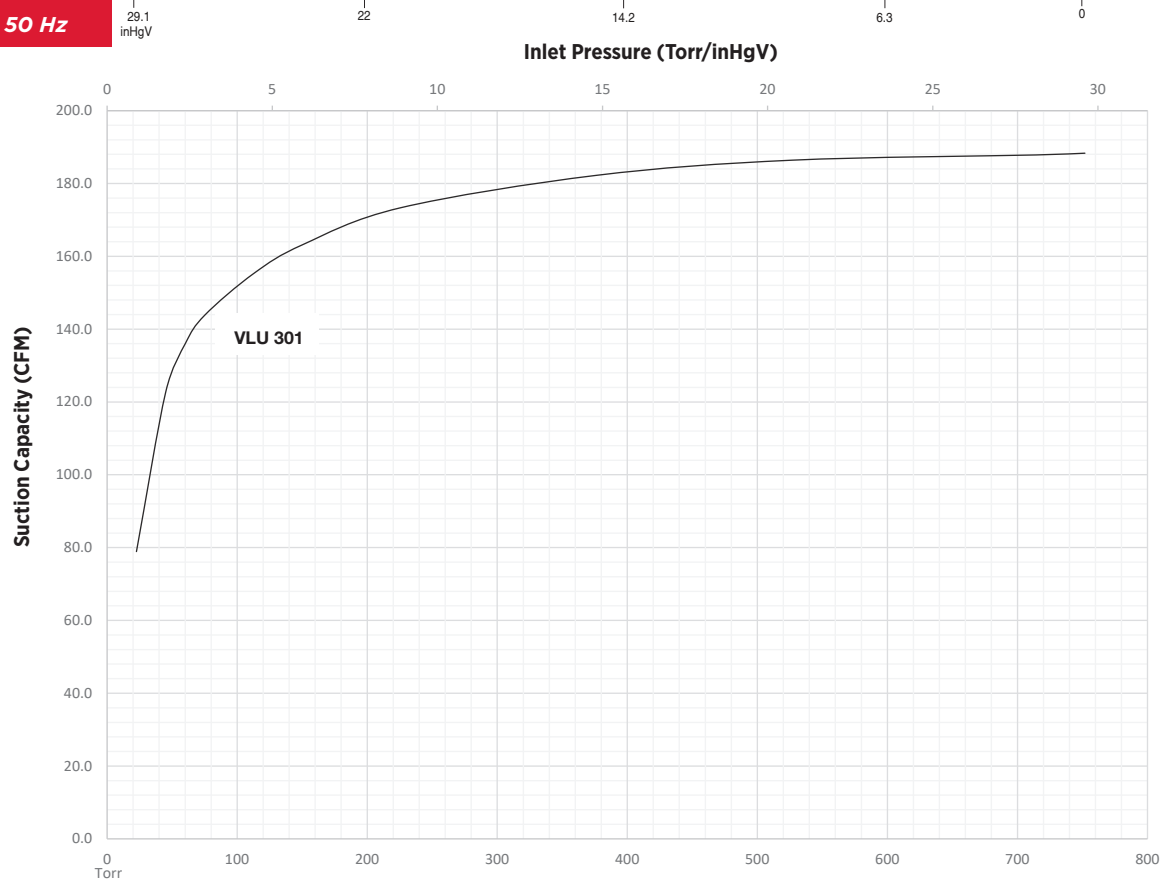
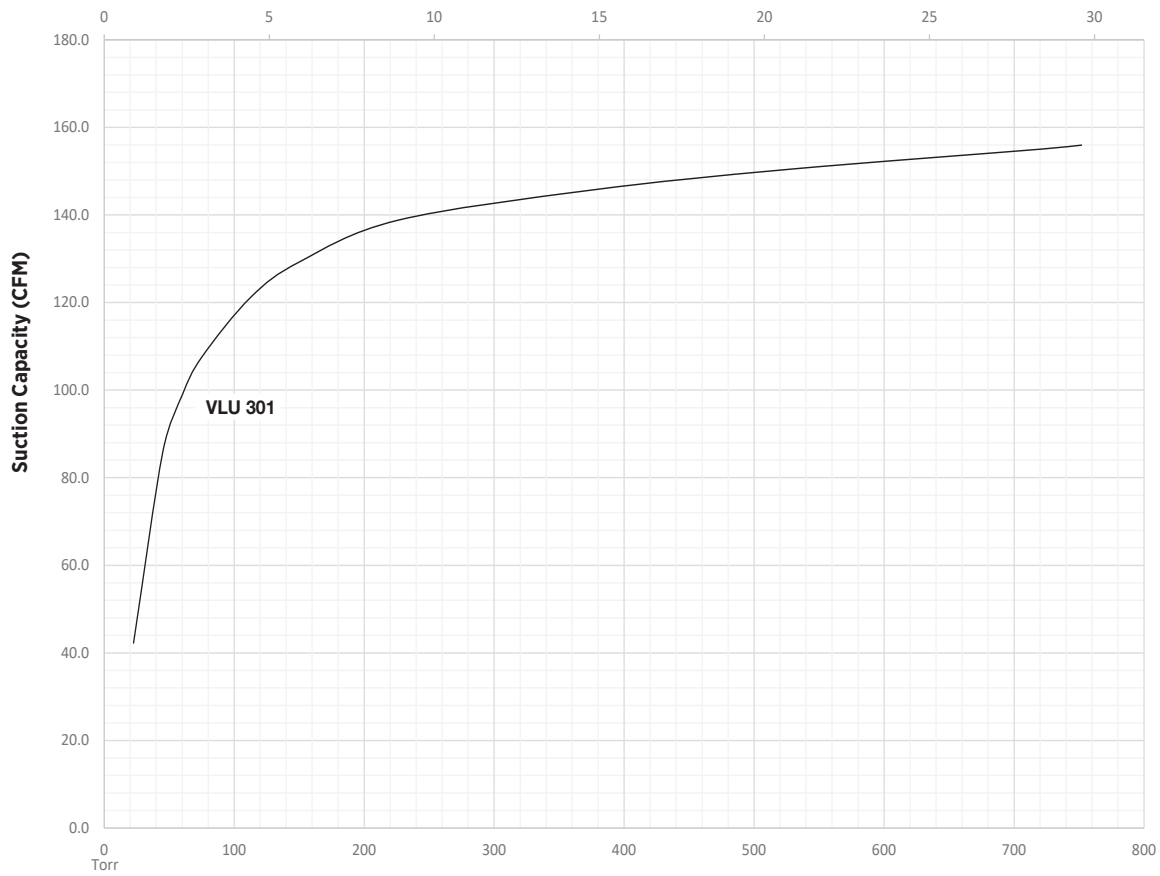

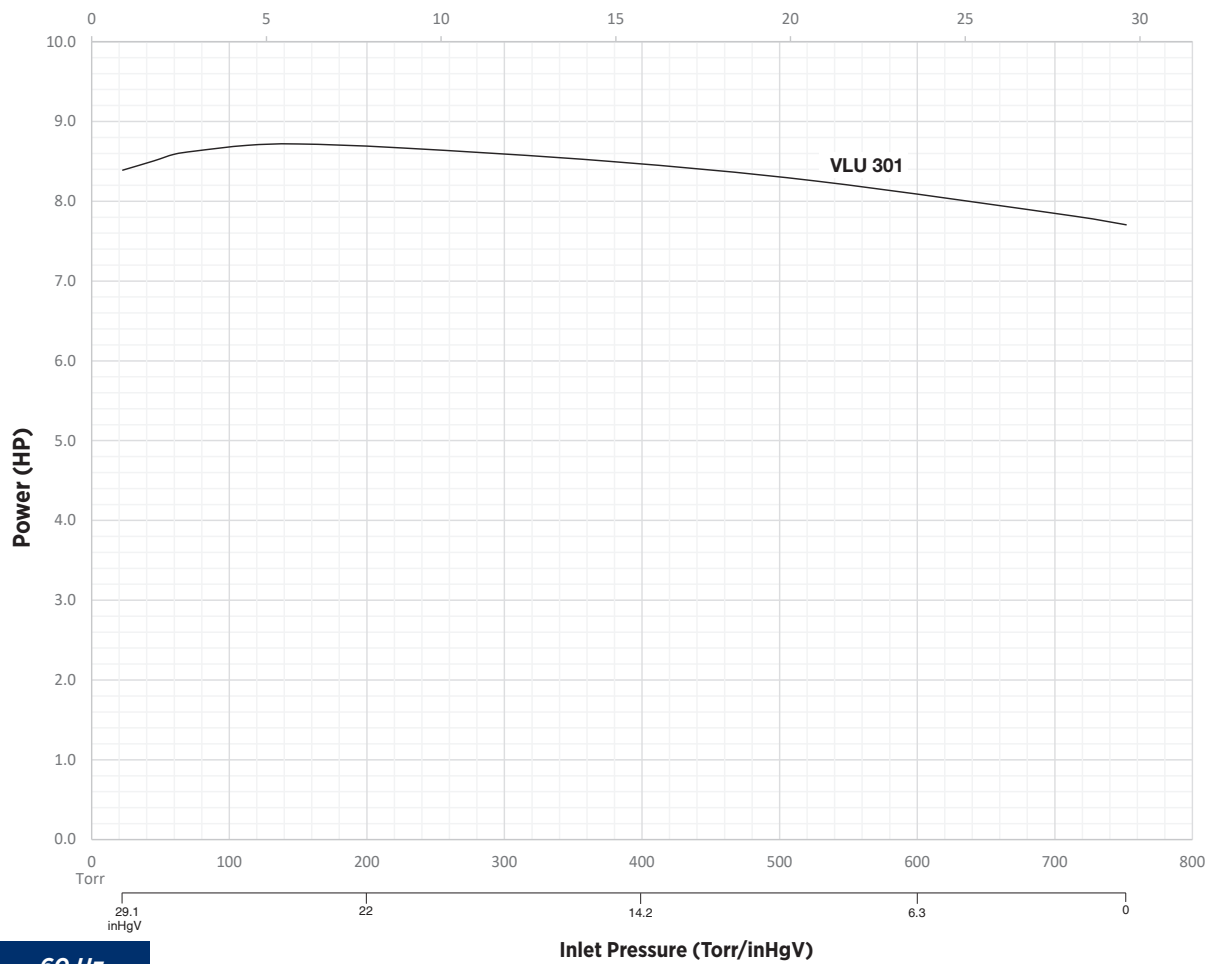
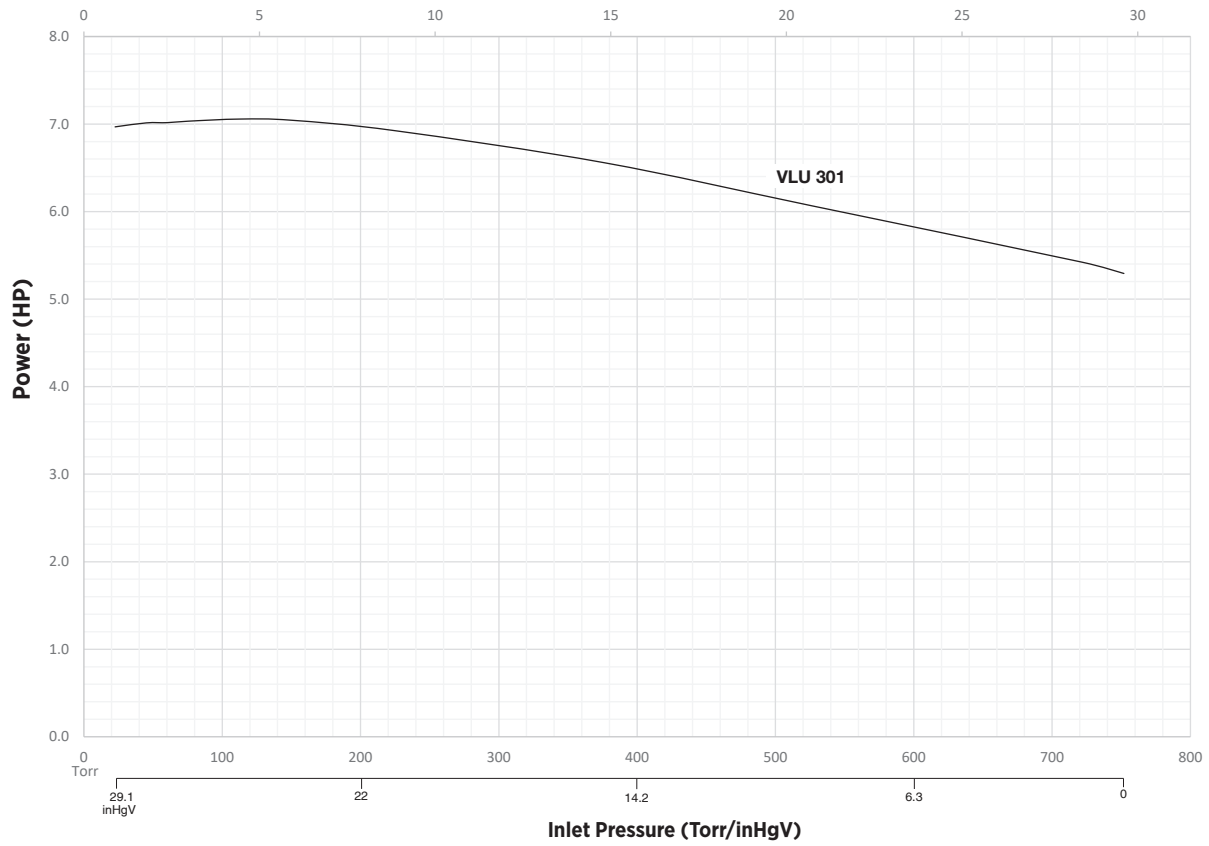



www.ElmoRietschle.com

©2024 Industrial Technologies and Services, LLC.
D892-NA_VLU_301



Please recycle after use.

